

NOTICE!!

These documents have been scanned!

Do not place un-scanned documents beneath this notice!

Do not remove this notice from this file!

GPO Jacket No. 560-102
Print Order 61540
Rise Business Services, LLC
Job=AZ15 5/21/2019



Box Number= AZ15075



Claim Begin-End: AMC452464-AMC452465

1 Initial Receipt



AZ15075-10

AMC452444-AMC452831

United States Department of the Interior
Bureau of Land Management
 DIV OF LANDS, MINRLS & ENERGY
 ONE N CENTRAL AVE
 PHOENIX, AZ 85004 -4427
 Phone: 602-417-9200

Receipt	
No:	4309382

Transaction #: 4425750
Date of Transaction: 11/19/2018

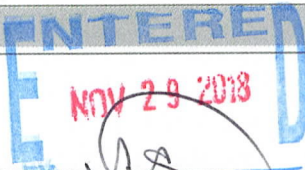
CUSTOMER:	
JOHN MATHIS PO BOX 712 CONGRESS,AZ 85332-0712 US	

LINE #	QTY	DESCRIPTION	REMARKS	UNIT PRICE	TOTAL
1	2.00	LOCATABLE MINERALS / MINING CLAIMS-NEW,UNADJUD, ONE OR MORE AUTH NOS / NEW MINING CLAIM PROCESSING FEE CASES: AMC452464/\$20.00, AMC452465/\$20.00		- n/a -	40.00
2	2.00	LOCATABLE MINERALS / MINING CLAIMS-NEW,UNADJUD, ONE OR MORE AUTH NOS / NEW MINING CLAIMS LOCATION FEE CASES: AMC452464/\$37.00, AMC452465/\$37.00		- n/a -	74.00
3	2.00	LOCATABLE MINERALS / MINING CLAIMS-NEW,UNADJUD, ONE OR MORE AUTH NOS / NEW MINING CLAIMS MAINTENANCE FEE CASES: AMC452464/\$310.00, AMC452465/\$310.00		- n/a -	620.00
TOTAL:					\$734.00

PAYMENT INFORMATION			
1	AMOUNT:	734.00	POSTMARKED: N/A
	TYPE:	CASH	RECEIVED: 11/19/2018
	NAME:	MATHIS, JOHN PO BOX 712 CONGRESS AZ 85332-0712 US	

REMARKS

This receipt was generated by the automated BLM Collections and Billing System and is a paper representation of a portion of the official electronic record contained therein.

NOTICE!!

These documents have been scanned!

Do not place un-scanned documents beneath this notice!

Do not remove this notice from this file!

GPO Jacket No. 560-102
Print Order 61540
Rise Business Services, LLC
Job=AZ15 5/21/2019



Box Number= AZ15075



Claim Begin-End: AMC452464-AMC452465

2 Correspondence



AZ15075-10

AMC452444-AMC452831

**NO
DOCUMENTS
FOUND**

NO DOCUMENTS FOUND
NO DOCUMENTS FOUND

NOTICE!!

These documents have been scanned!

Do not place un-scanned documents beneath this notice!

Do not remove this notice from this file!

GPO Jacket No. 560-102
Print Order 61540
Rise Business Services, LLC
Job=AZ15 5/21/2019



Box Number= AZ15075



Claim Begin-End: AMC452464-AMC452465

3 Transfers



AZ15075-10

AMC452444-AMC452831

**NO
DOCUMENTS
FOUND**

NO DOCUMENTS FOUND
NO DOCUMENTS FOUND

NOTICE!!

These documents have been scanned!

Do not place un-scanned documents beneath this notice!

Do not remove this notice from this file!

GPO Jacket No. 560-102
Print Order 61540
Rise Business Services, LLC
Job=AZ15 5/21/2019



Box Number= AZ15075



Claim Begin-End: AMC452464-AMC452465

4 Annual Filings



AZ15075-10

AMC452444-AMC452831

**NO
DOCUMENTS
FOUND**

NO DOCUMENTS FOUND
NO DOCUMENTS FOUND

NOTICE!!

These documents have been scanned!

Do not place un-scanned documents beneath this notice!

Do not remove this notice from this file!

GPO Jacket No. 560-102
Print Order 61540
Rise Business Services, LLC
Job=AZ15 5/21/2019



Box Number= AZ15075



Claim Begin-End: AMC452464-AMC452465

5 Miscellaneous



AZ15075-10

AMC452444-AMC452831

**NO
DOCUMENTS
FOUND**

NO DOCUMENTS FOUND
NO DOCUMENTS FOUND

NOTICE!!

These documents have been scanned!

Do not place un-scanned documents beneath this notice!

Do not remove this notice from this file!

GPO Jacket No. 560-102
Print Order 61540
Rise Business Services, LLC
Job=AZ15 5/21/2019



Box Number= AZ15075



Claim Begin-End: AMC452464-AMC452465

6 Location Notices-Amendments and Supporting Documents



AZ15075-10

AMC452444-AMC452831

MINING CLAIM STATUS REPORT

Data Entered: 11/29/2018

MTP Checked By: REK
GEO Checked By: _____

LEAD SERIAL NUMBER: AMC 452464 thru AMC 452465

NUMBER OF CLAIMS & TYPE:

LODE _____
2 PLACER
ASSOCIATION PLACER _____
MILL SITE _____
TUNNEL SITE _____

CHARGES:

Processing Fee @ \$20 = \$ 40
Location Fee @ \$37 = \$ 74
Maintenance Fee @ \$155 = \$ _____
Add'l Maint Fee for Assoc Placer = \$ 620
SUBTOTAL \$ _____
Other Fees \$ _____
Other Fees \$ _____
TOTAL \$ 73400

TOTAL ACREAGE: 40 Per Claim
(Placer Only)

NUMBER OF LOCATORS: 2

DOCUMENTS RECEIVED VIA: Over-the-Counter Mail TIMELY FILED: Yes No

LEGAL DESCRIPTION: T 9N R 4W SEC 17
T _____ R _____ SEC _____
T _____ R _____ SEC _____
T _____ R _____ SEC _____
T _____ R _____ SEC _____

BLM FOREST SERVICE WILDERNESS AREA SUBJ TO PL 359: Yes No

SPLIT ESTATE: N/A SX PX OTHER
SRHA Was proper Notice filed if located on SHRA Land? Yes No

RECONVEYED MINERALS ON BLM LAND REQUIRE OPENING ORDER FROM 1944 TO 1993:
Open to Entry On _____ N/A

COMMENTS/STATUS: VOID PARTIALLY VOID PVT MINERALS WITHDRAWN LANDS
OTHER

Claimant acknowledges that portions of the following claim(s) site(s) may be void or voidable.

Printed Name of Claimant _____ Signature of Claimant _____

*****FINAL ADJUDICATION*****

DATE _____ INITIALS _____

Rect 4309362

John Mathis
PO Box 712
Congress, AZ, 85332



LOCATION NOTICE FOR PLACER MINING CLAIM

Amendment BLM Serial # 452464

NOTICE IS HEREBY GIVEN that the

Stanton West

placer mining claim has been located by

John Mathis

whose current mailing address is:

PO Box 712 Congress, AZ. 85332

BLM
Date
Stamp

2018 NOV 19 A 11: 26
PHOENIX, ARIZONA

RECEIVED
BLM AZ STATE OFFICE

The general course of this claim is **East to West** and it is situated in **Yavapai** County, Arizona. This claim is **1320** feet in length and **1320** feet in width.

40 Acres Total Claim Acreage. This claim runs from the location monument on which this location notice is posted at the **NW** corner of the claim approximately **1320** feet in a **South** direction from the **North** end line and **1320** feet in a **East** direction from the **West** end line. This claim is marked by four monuments, one at each corner of the claim. The location monument on which this notice is posted is situated within Section **17**, Township **9N**, Range **4W**, Gila Salt River Base and Meridian, Arizona. This claim encompasses portions of the following legal subdivision(s) if located by legal subdivision or the following quarter section(s), section(s), Township(s) and Range(s) **SE ¼ of the SW ¼ of Sec. 17, T9N, R4W**, Gila Salt River Base and Meridian, Arizona. The locality of this claim with reference to some natural object or permanent monument and additional information (if any) concerning its locality are as follows: **The SE corner of the claim is 2640' West of the SE Corner of Sec 17, T9N, R4W.**

The above information is shown on the attached map. DATED AND POSTED on the ground this **27th** day of **September, 2018**.

Locators:

Printed Name John Mathis Signature(s)

Address: PO Box 712 Congress, AZ. 85332

Printed Name Dominic Ricci Signature(s)

Address: 39833 Saint Honore Drive, Murrieta, CA 92563

AH0452464

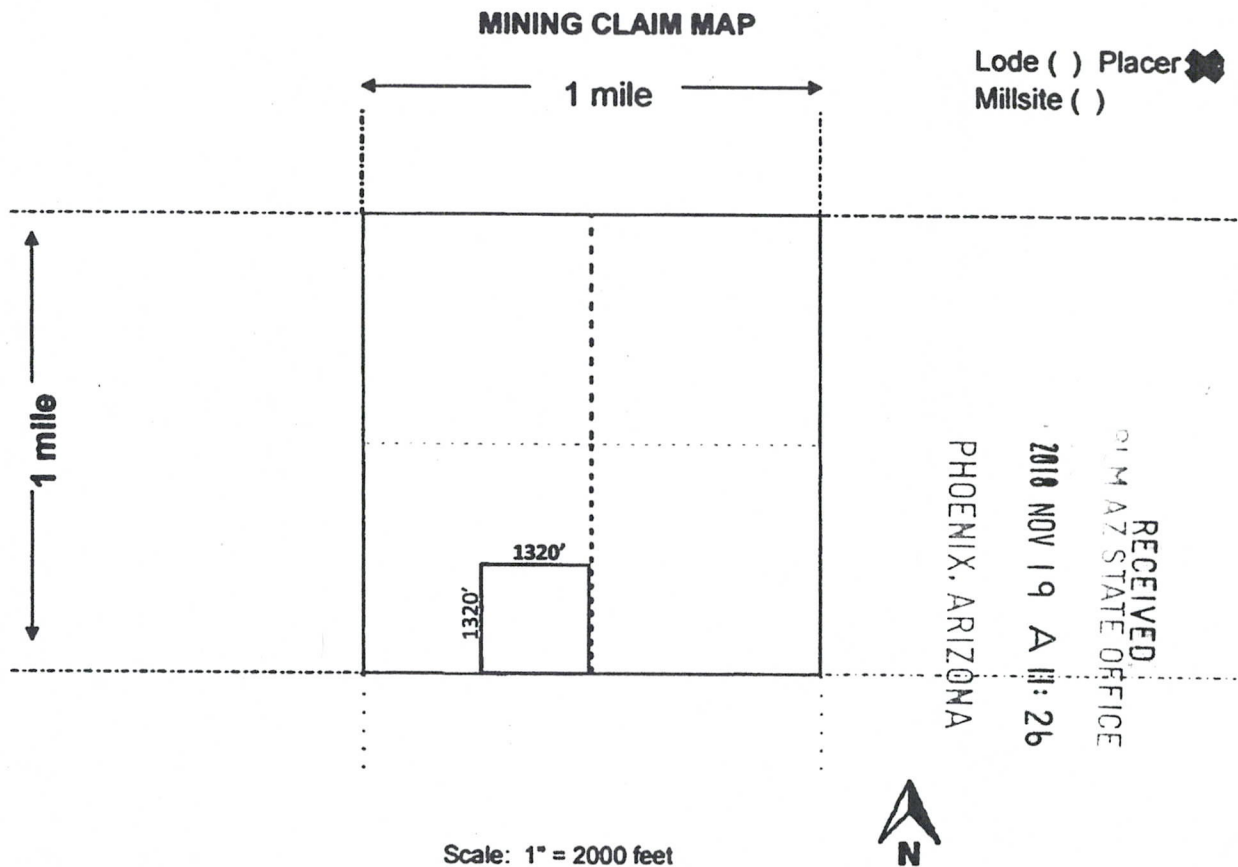

1. The above map depicts the STANTON WEST mining claim, which is located in Section(s) 17, Township 9N, Range 4W, Gila and Salt River Base and Meridian, Yavapai County, Arizona.

Total claim acreage is 40 Acres.

2. The type of corner and location monuments used are as follows: Capped PVC, Standing >5' tall.

3. The bearings and distances in degrees and feet between claim corners and to a public land survey monument are as depicted on the map. The SE corner of the claim is 2640' West of the SE Corner of Sec 17, T9N, R4W.

4. If the claim is a placer or millsite claim with exterior limits conforming to legal subdivisions of the public survey, provide a legal description of the SE ¼ of the SW ¼ of Sec. 17, T9N, R4W of the Gila and Salt River Base and Meridian, Yavapai County, Arizona.

A110452464

John Mathis
PO Box 712
Congress, AZ. 85332



LOCATION NOTICE FOR PLACER MINING CLAIM

Amendment BLM Serial # 452 465

NOTICE IS HEREBY GIVEN that the

Stanton East

placer mining claim has been located by

John Mathis

whose current mailing address is:

PO Box 712 Congress, AZ. 85332

BLM Date Stamp	2018 NOV 19 A 11: 26 PHOENIX, ARIZONA
----------------------	--

RECEIVED
RIM AZ STATE OFFICE

The general course of this claim is **East to West** and it is situated in **Yavapai** County, Arizona. This claim is **1320** feet in length and **1320** feet in width.

40 Acres Total Claim Acreage. This claim runs from the location monument on which this location notice is posted at the **NW** corner of the claim approximately **1320** feet in a **South** direction from the **North** end line and **1320** feet in a **East** direction from the **West** end line. This claim is marked by four monuments, one at each corner of the claim. The location monument on which this notice is posted is situated within Section **17**, Township **9N**, Range **4W**, Gila Salt River Base and Meridian, Arizona. This claim encompasses portions of the following legal subdivision(s) if located by legal subdivision or the following quarter section(s), section(s), Township(s) and Range(s) **SE ¼ of the SE ¼ of Sec. 17, T9N, R4W**, Gila Salt River Base and Meridian, Arizona. The locality of this claim with reference to some natural object or permanent monument and additional information (if any) concerning its locality are as follows: **The SE corner of the claim is the SE Corner of Sec 17, T9N, R4W.**

The above information is shown on the attached map. DATED AND POSTED on the ground this **27th** day of **September, 2018**.

Locators:

Printed Name John Mathis Signature(s)

Address: PO Box 712 Congress, AZ. 85332

Printed Name Dominic Ricci Signature(s)

Address: 39833 Saint Honore Drive, Murrieta, CA 92563

AN0452465

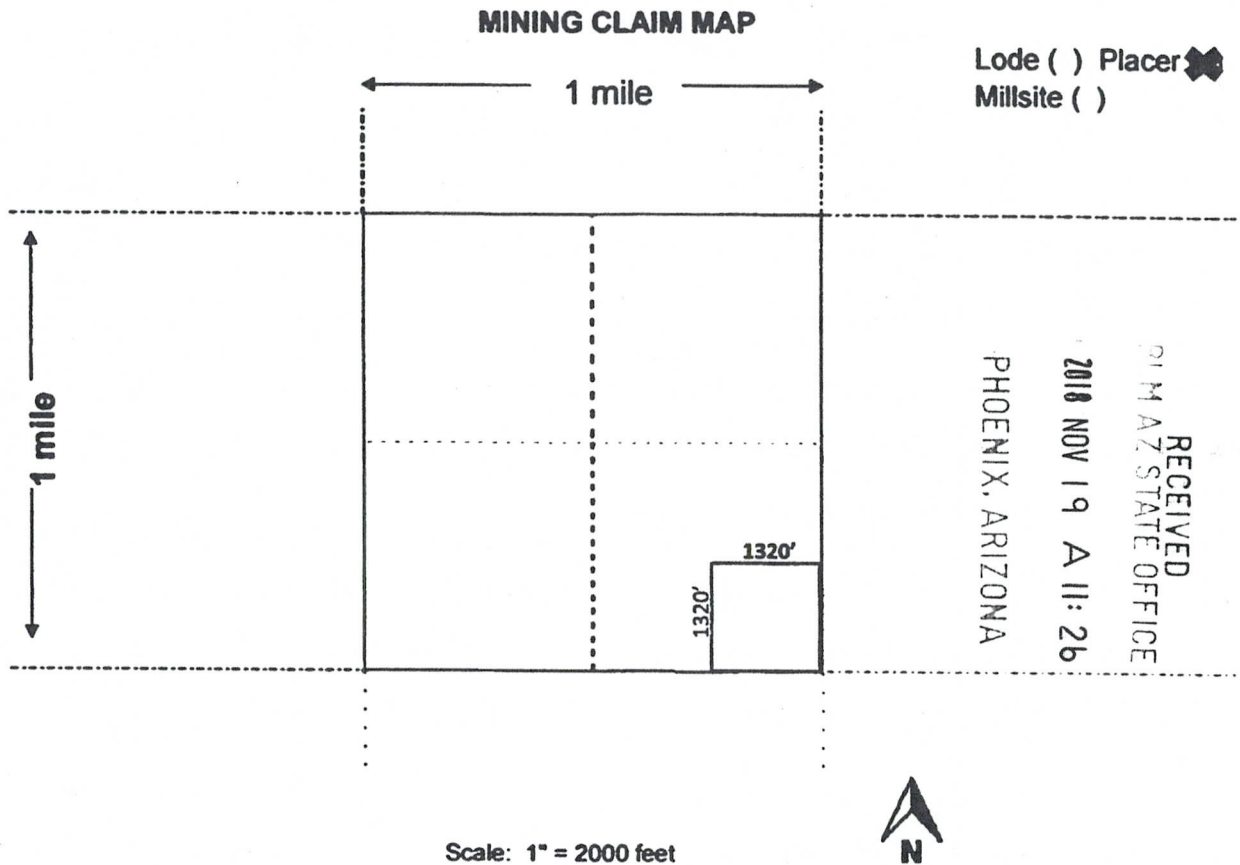

1. The above map depicts the STANTON EAST mining claim, which is located in Section(s) 17, Township 9N, Range 4W, Gila and Salt River Base and Meridian, Yavapai County, Arizona.

Total claim acreage is 40 Acres.

2. The type of corner and location monuments used are as follows: Capped PVC, Standing >5' tall.

3. The bearings and distances in degrees and feet between claim corners and to a public land survey monument are as depicted on the map. The SE corner of the claim is the SE Corner of Sec 17, T9N, R4W.

4. If the claim is a placer or millsite claim with exterior limits conforming to legal subdivisions of the public survey, provide a legal description of the SE ¼ of the SE ¼ of Sec. 17, T9N, R4W of the Gila and Salt River Base and Meridian, Yavapai County, Arizona.

A110452465



LR2000 Internal

CR Geographic Report with Land

[Download User Guide \(pdf\)](#)

Purpose: This report produces a geographic listing of case information based on retrieval by Meridian/Township/Range. This report format will display the case type, case disposition, meridian, township, range, section, survey type, survey number, surface management agency, pending actions, serial number, and total case acres.



No Results

The specified criteria didn't result in any data. This is often caused by applying filters and/or selection steps that are too restrictive or that contain incorrect values. Please check your analysis filters and selection steps, and try again. The filters or selection steps currently being applied are shown below.

Filters

Disposition is equal to **AUTHORIZED, CANCELLED, EXPIRED, PENDING, REJECTED, RELINQUISHED, WITHDRAWN**
and Meridian Township Range Section is equal to **14 0090N 0040W 017 SW**
and Admin State is equal to **AZ**

[Return](#) - Refresh

LR2K Home CR-24



LR2000 Internal

CR Geographic Report with Land

[Download User Guide \(pdf\)](#)

Purpose: This report produces a geographic listing of case information based on retrieval by Meridian/Township/Range. This report format will display the case type, case disposition, meridian, township, range, section, survey type, survey number, surface management agency, pending actions, serial number, and total case acres.

No Results

The specified criteria didn't result in any data. This is often caused by applying filters and/or selection steps that are too restrictive or that contain incorrect values. Please check your analysis filters and selection steps, and try again. The filters or selection steps currently being applied are shown below.

Filters

Disposition is equal to **AUTHORIZED, CANCELLED, EXPIRED, PENDING, REJECTED, RELINQUISHED, WITHDRAWN**
and Meridian Township Range Section is equal to **14 0090N 0040W 017 SE**
and Admin State is equal to **AZ**

[Return - Refresh](#)

